

**STATE OF MISSISSIPPI  
TRIANGULATION DIAGRAM  
U.S. DEPARTMENT OF COMMERCE**

NATIONAL OCEANIC AND ATMOSPHERIC ADMINISTRATION  
NATIONAL GEODETIC NETWORK  
WASHINGTON, D. C.  
November 1971  
HORIZONTAL CONTROL

Additional triangulation and traverse along the Mississippi River will be found in the publications "Triangulation along the Mississippi River, Memphis to Vicksburg," and "Triangulation along the Mississippi River, Vicksburg to New Orleans and Atchafalaya River," Volume 1, by the Corps of Engineers, U. S. Army.  
Copies of this publication may be procured from Army Topographic Command, 6500 Brooks Lane, Washington, D. C. 20315.

Additional triangulation in the areas outlined by heavy broken lines will be found on triangulation diagrams indicated by numbers.

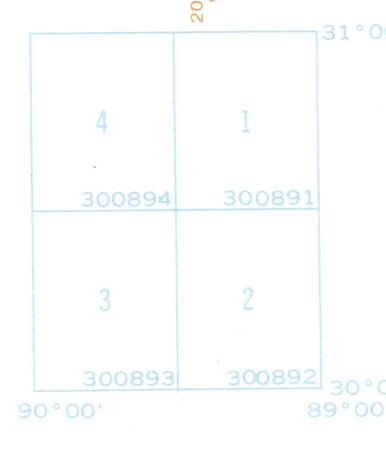
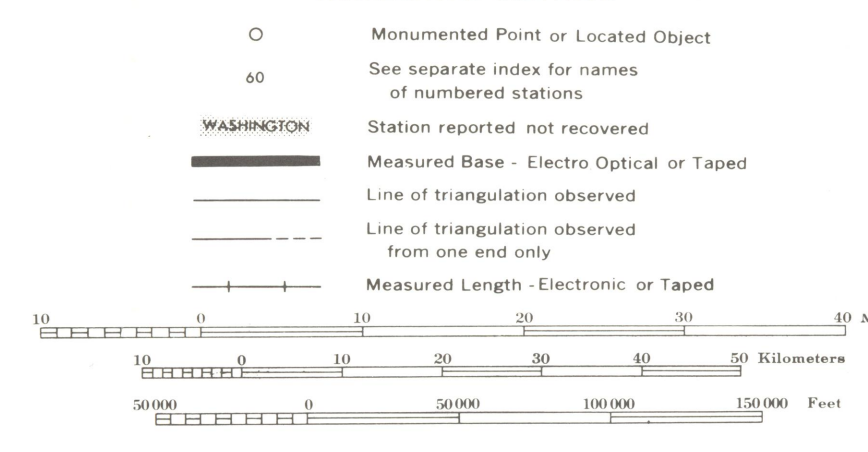

Note: Data may be requested by quadrangle, county, or other unit. Since publication of data in quadrangle units may not be complete for this State, requests for information by quadrangle number will be supplied with data in whatever form is available.  
Each 30 minute quadrangle (shown in blue) is identified in the southeast corner by a six digit number showing successively degrees of latitude, degrees of longitude, and position in its one degree quadrangle.

Information may be obtained from the Geodesy Division, NOAA, Rockville, Maryland 20852

4565